

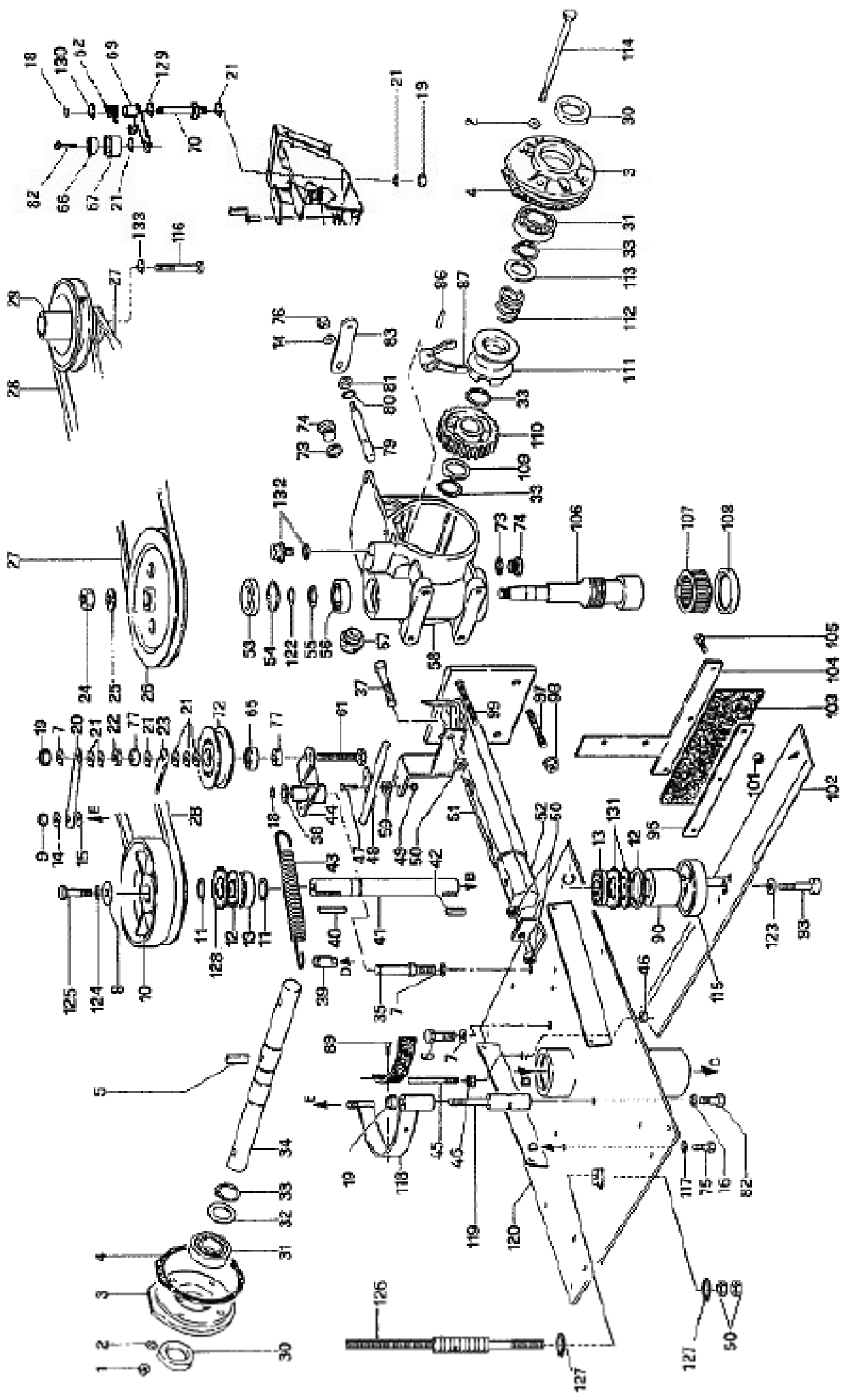

Machinery | Spares | Consumables
(Specialist suppliers to Tool Hire & Garden Machinery Dealers)

FT155 Parts List





Item No.	Part No.	Description
1	02.001.0.001.0	Nut M8 cieco 0281
2	02.001.0.002.0	Washer S-1160
3	02.066.0.026.0	Cover (172513)
4	02.066.0.076.0	Gasket (172521)
5	02.275.0.072.0	Spline
6	02.252.0.006.0	Screw TE 10x1.25x30
7	02.025.0.038.0	Washer.D10 0254/1
8	02.228.0.025.0	Washer
9	02.002.0.009.0	Nut Self-blocking8 h8,5
10	02.252.0.010.0	Pulley for Shaft
11	02.007.0.010.0	Seeger E25 0510
12	02.007.0.045.0	Seeger I47 0529
13	02.030.0.116.0	Bearing 6005 2RS C3
14	02.001.0.005.0	Washer 0252/1
15	02.001.0.007.0	Washer .D8
16	02.006.0.011.0	Washer gr.D10 0243
18	02.016.0.016.0	Seeger E12 0539
19	02.011.0.052.0	Nut A.M10 h.10
20	02.252.0.020.0	Rod Brake
21	02.011.0.034.0	Washer bevelled d.10
22	02.006.0.014.0	Nut M10 h.6 0265/1
23	02.252.0.023.0	Little Plate Drive Belt
24	02.030.0.006.0	Nut 14X1,5h8 0278/1
25	02.030.0.007.0	Washer O.14 0256/1
26	02.217.0.012.0	Pulley driven
27	02.311.0.007.1	Belt X10x740 676K SOLO 531
28	02.231.0.028.1	Belt XDV 48-590 KEVLAR
29	02.252.0.029.0	Pulley for Shaft engine

Item No.	Part No.	Description
30	02.066.0.029.0	Seal Ring25x47x10
31	02.001.0.009.0	Bearing 6205 0304
32	02.008.0.022.0	Spacer F-592
33	02.007.0.010.0	Seeger E25 0510
34	02.223.0.032.0	Shaft p/ruote F180/1900/FT155
35	02.252.0.035.0	Bolt for Tensioner
37	02.004.0.012.0	Screw TE M8X50 0078
38	02.007.0.008.0	Spacer I-705
39	02.231.0.039.0	Bolt Hook Spring
40	02.313.0.016.0	Key
41	02.252.0.041.0	Shaft Support Pulley FT-155
42	02.001.0.048.0	Key 5x5x20 0564
43	02.231.0.043.0	Spring Brake blade FT155
44	02.231.0.044.0	Tensioner FT-155
45	02.231.0.045.0	Bolt
46	02.001.0.073.0	Nut M6 0261
47	02.097.0.176.0	Screw M5X16 TE0018
48	02.252.0.048.0	DriveBelt
49	02.014.0.030.0	Nut Self-blocking M5 h.6,5
50	02.001.0.006.0	Nut M8 H.6,5
51	02.252.0.051.0	Flange Support ing Hood
52	02.252.0.052.0	Spacer esagonale
53	02.007.0.020.0	Seal Ring 20.47.7 0416
54	02.007.0.045.0	Seeger I47 0529
55	02.007.0.018.0	Spacer
56	02.007.0.022.0	Bearing 6204 0303
57	02.252.1.057.0	Washer
58	02.217.0.033.0	
59	02.006.0.049.0	Washer .6X18

Item No.	Part No.	Description
61	02.252.0.061.0	Screw TE M10x60
65	02.047.0.039.0	Bearing 6200 2RS
67	02.014.0.077.0	Pulley
66	02.121.0.006.0	Bearing 6000 2RS
69	02.311.0.021.0	Tensioner lower
70	659098T0	
72	02.252.0.072.0	Pulley Tensioner FT-155 S
73	02.009.0.021.0	Washer A-16
74	02.252.0.074.0	Cap
75	02.001.0.038.0	Screw TE M8X16 0070
76	02.001.0.008.0	Nut M8 H=8 0263
77	02.231.0.021.0	Spacer
79	02.217.0.034.0	Rod Lever sblocaggio
80	02.032.1.023.0	Nut Self-blockingM10 A. 0282
81	02.007.0.008.0	Spacer I-705
82	02.006.0.034.0	Screw TE M10X20 0118
83	02.309.0.043.0	Little lever engaging
86	02.017.0.092.0	Jack Elas.5X22 0601
87	02.066.0.059.0	Fork(172519)
89	02.252.0.089.0	Screw TSCEI M 4x8
90	02.275.0.026.0	
93	02.252.1.093.0	Screw TCEI M 10X1,25 L=55
96	02.231.0.096.0	Little Plate
97	02.231.0.097.0	Bolt
98	02.270.0.012.0	Nut
99	02.231.0.099.0	Bolt M8X25 UNI 5911
101	02.010.0.011.0	Nut Self-blockingM6 h.6
102	02.252.0.102.0	blade FT-155
103	02.231.0.103.0	Strip

Item No.	Part No.	Description
104	02.231.0.104.0	Bracket
105	02.231.0.050.0	Screw TE M6x18
106	02.231.0.106.0	Screw s/fine
107	02.217.0.062.0	Needle Cage HK 45-16
108	02.217.0.063.0	Seal Ring 45x60x7 RP
109	02.008.0.022.0	Spacer F-592
110	02.217.0.065.0	crown elic. Z30
111	02.217.0.066.0	Collar
112	02.217.0.067.0	Spring dis. Wheels F180
113	02.066.0.063.0	Washer (P903)
114	02.066.0.064.0	Screw M8X140 TE0090
115	02.252.0.115.0	Cover
116	02.115.0.004.0	Screw 3/8.24X2"1/2
117	02.003.0.016.0	Washer gr.D.8
118	02.252.0.118.0	Runner with ferodo
119	02.252.0.119.0	Support Brake
120	02.253.0.105.0	Support Hood reg.FT155
121	02.014.0.089.0	Key
122	02.006.0.054.0	Seeger E20 0509
123	02.373.0.002.0	Washer grower WH3/8"
124	02.282.0.002.0	Washer
125	02.275.0.041.0	Screw TE 10X20
126	02.253.0.109.0	Screw regolazione
127	02.001.0.003.0	Spacer F-588
128	02.008.0.022.0	Spacer F-592
129	02.275.0.091.0	Spacer
130	02.006.0.071.0	Washer b.D12 0233
131	6HP04270	
132	02.287.0.078.0	Breather Plug
133	02.373.0.002.0	Washer grower WH3/8"

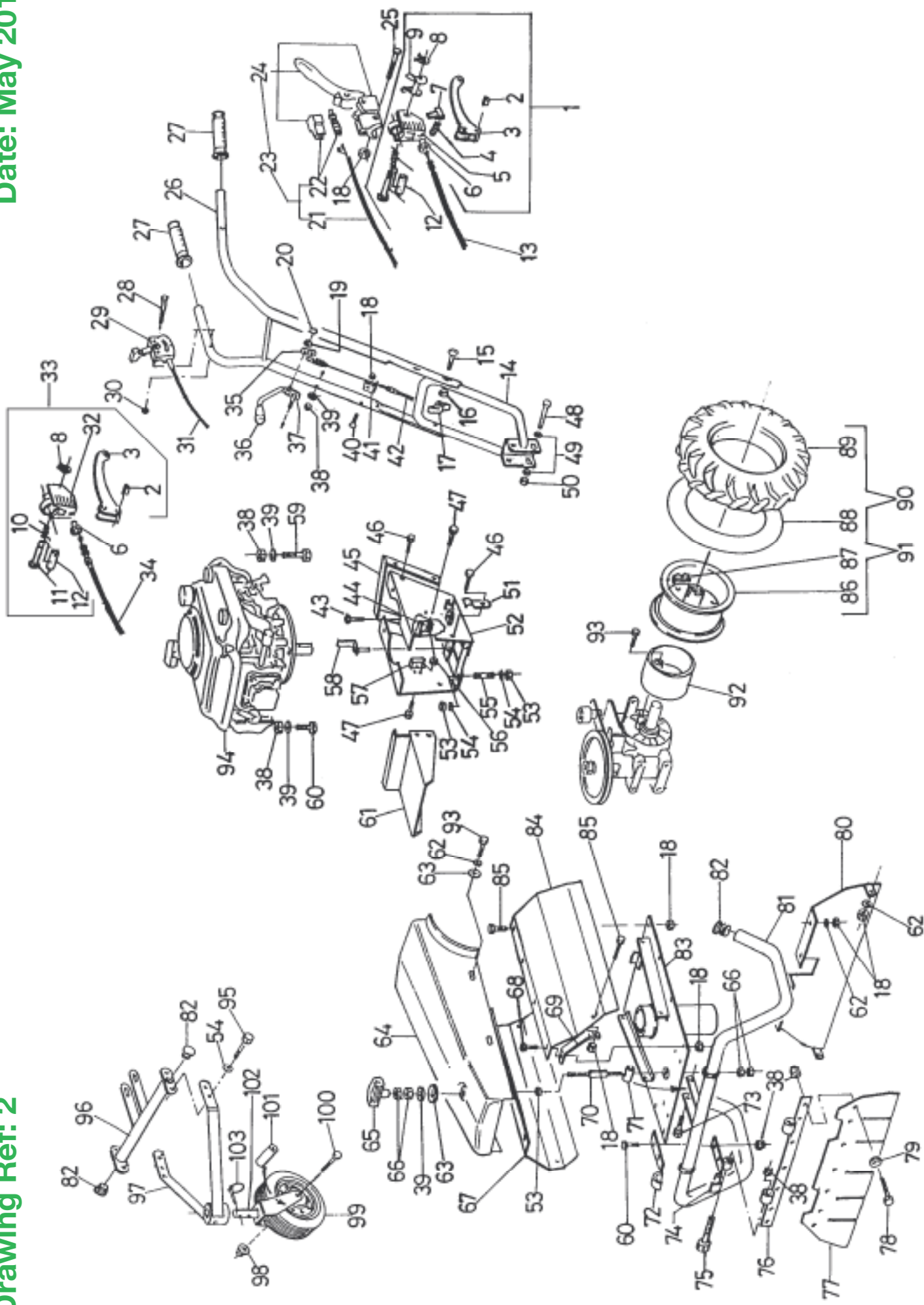

Item No.	Part No.	Description
1	02.253.2.001.0	Lever
2	02.288.0.039.0	Hook
3	02.288.0.038.0	Lever
4	02.288.0.068.0	Spring
5	02.253.2.005.0	Support Lever d.22 c/staz.
6	02.288.0.035.0	Sedan
7	02.288.0.047.0	Button left
8	02.288.0.036.0	Seeger
9	02.288.0.046.0	Sheet
10	02.288.0.034.0	Spring
11	02.288.0.033.0	Bolt
12	02.288.0.069.0	Spacer
13	02.253.2.013.0	WireOn/off.avanz.
14	02.216.0.053.0	Support Handle bar
15	02.219.0.060.0	Screw TTDE M 8x40
16	02.014.0.064.0	Washer in plastic
17	02.219.0.059.0	Knob for handle bar
18	02.010.0.011.0	Nut Self-blockingM6 h.6
19	02.001.0.003.0	Spacer F-588
20	02.026.0.009.0	Seeger RS5 0541
21	02.288.0.040.0	Wire stop ACME-INTERMOTOR
22	02.288.0.041.0	MicroSwitch complete
23	02.253.2.023.0	Wire stop c/ for lever
24	02.253.2.024.0	Lever stop engine
25	02.222.0.014.0	Screw TCE M 6x40
26	02.253.2.026.0	Handle bar FT155
27	02.271.0.001.0	Knob
28	02.222.0.014.0	Screw TCE M 6x40

Item No.	Part No.	Description
29	02.015.0.005.0	Throttle
30	02.003.0.012.0	Nut M 6
31	02.230.0.078.0	Throttle C/Wire FT155
32	02.310.0.010.0	Support for lever
33	02.310.0.005.0	Lever /Band
34	02.253.2.034.0	Wire Diseng. wheels
35	02.080.0.056.0	Lever (17A286)
36	02.024.0.010.0	Knob B-265
37	02.253.0.037.0	Lever releasing
38	02.002.0.009.0	Nut Self-blocking8 h8,5
39	02.001.0.007.0	Washer .D8
40	02.235.0.001.0	Screw TCB M 6x35
41	02.262.0.045.0	Support reg.
42	02.253.0.050.0	Wire engaging blade
43	02.002.0.018.0	Screw TE M8X25 0073
44	02.230.0.064.0	Support engine
45	02.230.0.055.0	Cover Rear
46	02.115.0.014.0	Screw M5X12 TE0017
47	02.097.0.176.0	Screw M5X16 TE0018
48	02.011.0.089.0	Screw TE M10X75 0129
49	02.011.0.034.0	Washer bevelled d.10
50	02.078.1.055.0	Nut M10 (0265)
51	02.230.0.063.0	Strain Relief
52	02.253.2.052.0	Support engine
53	02.001.0.008.0	Nut M8 H=8 0263
54	02.003.0.016.0	Washer gr.D.8
55	02.275.0.132.0	Bolt
56	02.253.2.056.0	Nut M 5
57	02.230.0.057.0	Nut M 5

Item No.	Part No.	Description
58	02.216.0.050.0	Bracket app.Belt
59	02.004.0.012.0	Screw TE M8X50 0078
60	02.009.0.029.0	Screw TE M8X40 0076
61	02.230.0.051.0	Guard front
62	02.006.0.049.0	Washer .6X18
63	02.002.0.005.0	Washer 10-1679
64	02.253.0.106.0	Hood FT 155 S reg. Red
65	02.219.0.028.0	Knob
66	02.216.0.073.0	Screw TE 8X35
67	02.253.2.067.0	Hood lat.Right
68	02.231.0.050.0	Screw TE M6x18
69	02.253.0.108.0	Rod Strip FT155
70	02.253.0.109.0	Screw regolazione
71	02.115.0.032.0	Cylinder
72	02.253.0.111.0	Little pulley upper FT-155
73	02.189.0.021.0	Screw Speciale
74	02.253.2.074.0	Support lower
75	02.253.2.075.0	Screw TCEI M8X60
76	02.253.2.076.0	Little Plate
77	02.253.2.077.0	Guard front
78	02.001.0.016.0	Screw TE 8X20
79	02.003.0.017.0	Washer 8x24
80	02.232.0.026.0	Strip
81	02.253.0.103.0	Fender reg.FT 155
82	02.253.0.104.0	Cap d.25
83	02.253.0.105.0	Support Hood reg.FT155
84	02.253.2.084.0	Hood lat. left
85	02.001.0.071.0	Screw TE M6x14
86	02.222.0.060.0	Rim

Item No.	Part No.	Description
87	02.032.1.024.0	Jack a scatto 10X40
88	02.216.0.079.0	Tube 3.50.6
89	02.216.0.078.0	Tyre 3.50.6 TRACTOR
90	02.222.0.078.0	wheelRight 3506
91	02.222.0.079.0	Wheel left 3506
92	02.222.0.058.0	Guard
93	02.222.0.057.0	Screw TCB M6x20
95	02.001.0.038.0	Screw TE M8X16 0070
96	02.253.2.096.0	Pipe
97	02.253.2.097.0	Bracket
98	02.200.1.037.0	Nut M10 c/rond.
99	02.200.0.002.2	Small wheel d.200
100	02.200.0.006.0	Screw TE M10X80
101	02.200.0.001.0	Bushing
102	02.253.2.102.0	Support
103	02.317.0.006.0	Jack a scatto