

AC1600 Air Conditioner

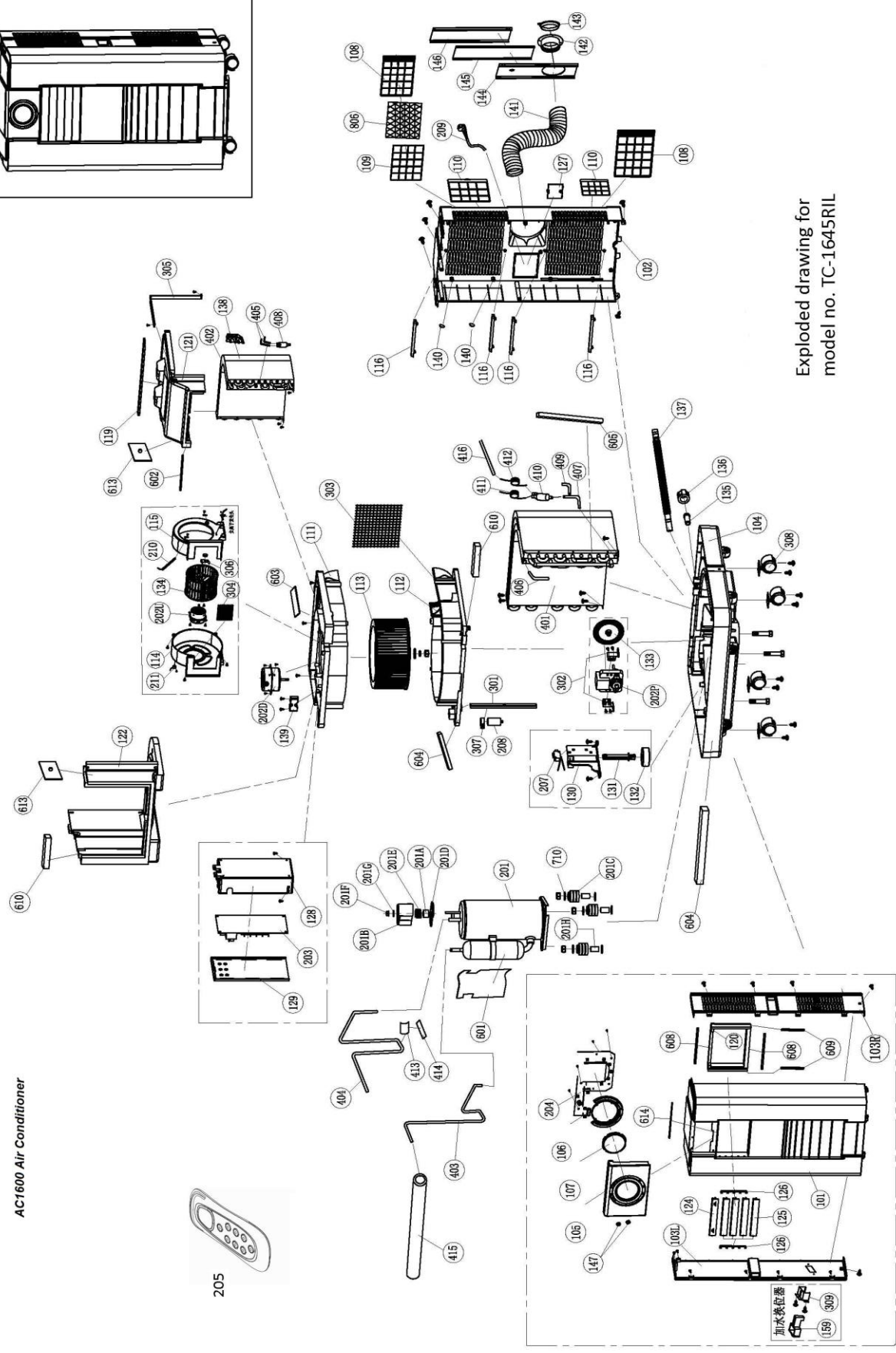
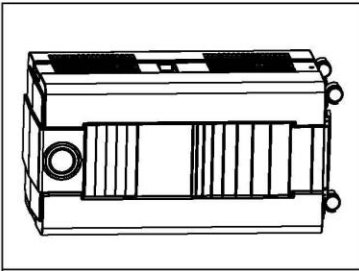

Exploded drawing for
model no. TC-1645RIL

加水装置
159 309

205

Part no.	Part name in English	Q'ty
-----------------	-----------------------------	-------------

PC/SET

A. PLASTIC PARTS

101	FRONT PANEL	1
102	REAR PANEL	1
103L	LEFT SIDE PANEL	1
103R	RIGHT SIDE PANEL	1
104	BOTTOM BASE	1
105	CONTROL PANEL	1
106	DIGITAL BUTTON	1
107	TRANSPARENT COVER	1
108	REAR FILTER	2
109	FIXER FOR REAR FILTER	1
110	SIDE FILTER	2
111	TOP FUNNEL FOR WIND-DUCT	1
112	BOTTOM FUNNEL FOR WIND-DUCT	1
113	DOWN FAN BLADE (FOR CONDENSOR)	1
114	LEFT WIND-DUCT	1
115	RIGHT WIND-DUCT	1
116	FILTER TRACK	4
117	FILTER FIXER	2
118	FRONT WIND PLATE	1
119	TOP FIXER	1
120	WATER-PROOF POLYFOAM FOR FRONT PANEL	1
121	POLYFOAM FOR UPPER WIND-DUCT	1
122	POLYFOAM FOR DOWN WIND-DUCT	1
124	MAIN LOUVER	1
125	SIDE LOUVER	4
126	LOUVER ROD	2
127	COVER FOR CORD COMPARTMENT	1
128	PROTECTIVE BOX FOR ELECTRIC PARTS	1
129	PLATE FOR BOX OF ELECTRONIC PARTS	1
130	MICRO SWITCH BASE	1
131	LEVER	1
132	FLOAT	1
133	PUMPING BLADE	1
134	UP FAN BLADE (FOR EVAPORATOR)	1
135	RUBBER STOPPER	1
136	WATER STOPPER	1

137	DRAINAGE PIPE	1
138	SENSOR FIXER	1
139	WIRING FIXER	1
140	SCREWS PLUG	2
141	EXHAUST PIPE	1
142	ROUND WINDOW CONNECTOR	1
143	COVER FOR ROUND WINDOW CONNECTOR	1
144	PVC WINDOW KIT (A)	1
145	PVC WINDOW KIT (B)	1
146	PVC WINDOW KIT (C) ...	1

B. ELECTRIC PARTS

201	COMPRESSOR	1
201A	OVERLOAD PROTECTOR	1
201B	PROTECTIVE COVER FOR COMPRESSOR	1
201C	RUBBER GROMMET	3
201D	PAD	1
201E	STEEL HELICAL SPRING	1
201F	NUT	1
201G	PAD FOR NUT	1
201H	ANTI-VIBRATION SOCKET	3
202D	DOWN MOTOR	1
202P	PUMP MOTOR	1
202U	UP MOTOR	1
203	MAIN P.C. BOARD	1
204	CONTROL P.C. BOARD	1
205	REMOTE CONTROL	1
207	MICRO SWITCH	1
208	COMPRESSOR CAPACITOR	1
209	POWER CORD	1
211	IONIZER	1

C. METAL CONSTRUCTION

301	MAIN FIXTURE	1
302	FIXTURE FOR PUMP MOTOR	2
303	HEAT-DISPENSATING SCREEN	1
304	SCREEN FOR TOP WIND-DUCT	1
305	FIXTURE FOR TOP WIND-DUCT	1

306	FIXING CLIP FOR FAN-BLADE	1
307	CAPACITOR FIXER	1
308	CASTER	4

D. METAL PARTS

401	CONDENSER	1
402	EVAPORATOR	1
403	SUCTION TUBE	1
404	DISCHARGING TUBE	1
405	INLET TUBE FOR EVAPORATOR	2
406	OUTLET TUBE FOR CONDENSOR	1
407	OUTLET TUBE FOR CONDENSOR	1
408	3 WAY VALVE BRANCH (E)	1
409	REFRIGERANT CHARGING TUBE	1
410	FILTER (A)	1
411	CAPILLARY - TOP	1
412	CAPILLARY - DOWN	1
413	DAMPER GLUE	1
414	PVC SLEEVE	1
415	THERMAL SLEEV	1
416	SLEEVE FOR CAPILLARY	1

E. WIRE MATERIALS

501	WIRE SET	1
-----	----------	---

F. FOAM PARTS

601	RUBBER FOAM FOR ACCUMULATOR	1
602	SEALED FOAM FOR TOP WIND-DUCT	1
603	WATER PROOF FOAM FOR TOP FUNNEL	1
604	SEALED FOAM FOR FUNNEL OF WIND-DUCT	2
605	SEALED FOAM FOR FRONT PROTECTIVE PLATE	1
608	FOAM FOR AIR VENT (A)	2
609	FOAM FOR AIR VENT (B)	2
610	SEALED FOAM FOR ACCESSORY PIPES	2
613	SEALED FOAM FOR WIND POLYFOAM	3
614	HEAT-INSULATION FOAM FOR FRONT PANEL	1

**G.
SCREWS**

701	SCREWS	1
-----	--------	---

H. PACKING MATERIALS

801	COLOR BOX	1
804	PACKAGE POLYFOAM (UP)	1
805	PACKAGE POLYFOAM (BASE)	1
806	ACTIVE CARBON FILTER	1
807	RATING LABEL	1
809	PLASTIC BAG FOR UNIT	1
810	INSTRUCTION MANUAL	1
811	PLASTIC BAG FOR I/M	1
812	PLASTIC BAG FOR REMOTE CONTROL	1
815	DIAGRAM	1
816	CONTINUOUS DRAINAGE STICKER	1