



MASSTER[®]
CLIMATE SOLUTIONS
MCS



USER AND MAINTENANCE BOOK	en
LIBRETTO USO E MANUTENZIONE	it
BEDIENUNGS- UND WARTUNGSANLEITUNG	de
MANUAL DE INSTRUCCIONES PARA EL USO Y MANTENIMIENTO	es
MANUEL D'UTILISATION ET DE MAINTENANCE	fr
HANDLEIDING VOOR GEBRUIK EN ONDERHOUD	nl
MANUAL DE USO E MANUTENÇÃO	pt
VEJLEDNING OM BRUG OG VEDLIGEHOELSE	da
KÄYTTÖ- JA HUOLTO-OHJE	fi
HEFTE FOR BRUK OG VEDLIKEHOLD	no
ANVÄNDAR- OCH UNDERHÅLLSHANDBOK	sv
INSTRUKCJA OBSŁUGI I KONSERWACJI	pl
РУКОВОДСТВО ПО ЭКСПЛУАТАЦИИ И ТЕХНИЧЕСКОМУ ОБСЛУЖИВАНИЮ	ru
PŘÍRUČKA PRO POUŽITÍ A ÚDRŽBU	cs
HASZNÁLATI ÉS KARBANTARTÁSI KÉZIKÖNYV	hu
PRIROČNIK Z NAVODILI ZA UPORABO IN VZDRŽEVANJE	sl
KULLANIM VE BAKIM KİTAPÇIĞI	tr
KNJIŽICA O UPORABI I ODRŽAVANJU	hr
NAUDOJIMO IR PRIEŽIŪROS KNYGELĖ	lt
LIETOŠANAS UN TEHNISKĀS APKOPES GRĀMATIŅA	lv
KASUTUS- JA HOOLDUSJUHEND	et
LIVRET DE UTILIZARE ŞI ÎNTREȚINERE	ro
PRÍRUČKA PRE POUŽITIE A ÚDRŽBU	sk
НАРЪЧНИК ЗА ИЗПОЛЗВАНЕ И ПОДДРЪЖКА	bg
ІНСТРУКЦІЯ КОРИСТУВАЧА ТА ОБСЛУГОВУВАННЯ ОБЛАДНАННЯ	uk
ΕΓΧΕΙΡΙΔΙΟ ΧΡΗΣΗΣ ΚΑΙ ΣΥΝΤΗΡΗΣΗΣ	el

BC 341

FIGURES - FIGURE - ABBILDUNGEN - FIGURAS - FIGURES - FIGUREN - FIGURAS - FIGURER - KUVAT - FIGURER - FIGURER - ILUSTRACJE - ИЛЛЮСТРАЦИИ - OBRÁZKY - ÁBRÁK - SLIKE - ŞEKİLLER - SLIKE - ILIISTRACIJOS - AT-TĒLI - JOONISED - IMAGINI - OBRÁZKY - СХЕМИ - ДАНИ - ΕΙΚΟΝΕΣ - 图示 - СУРЕТТЕМЕЛЕР

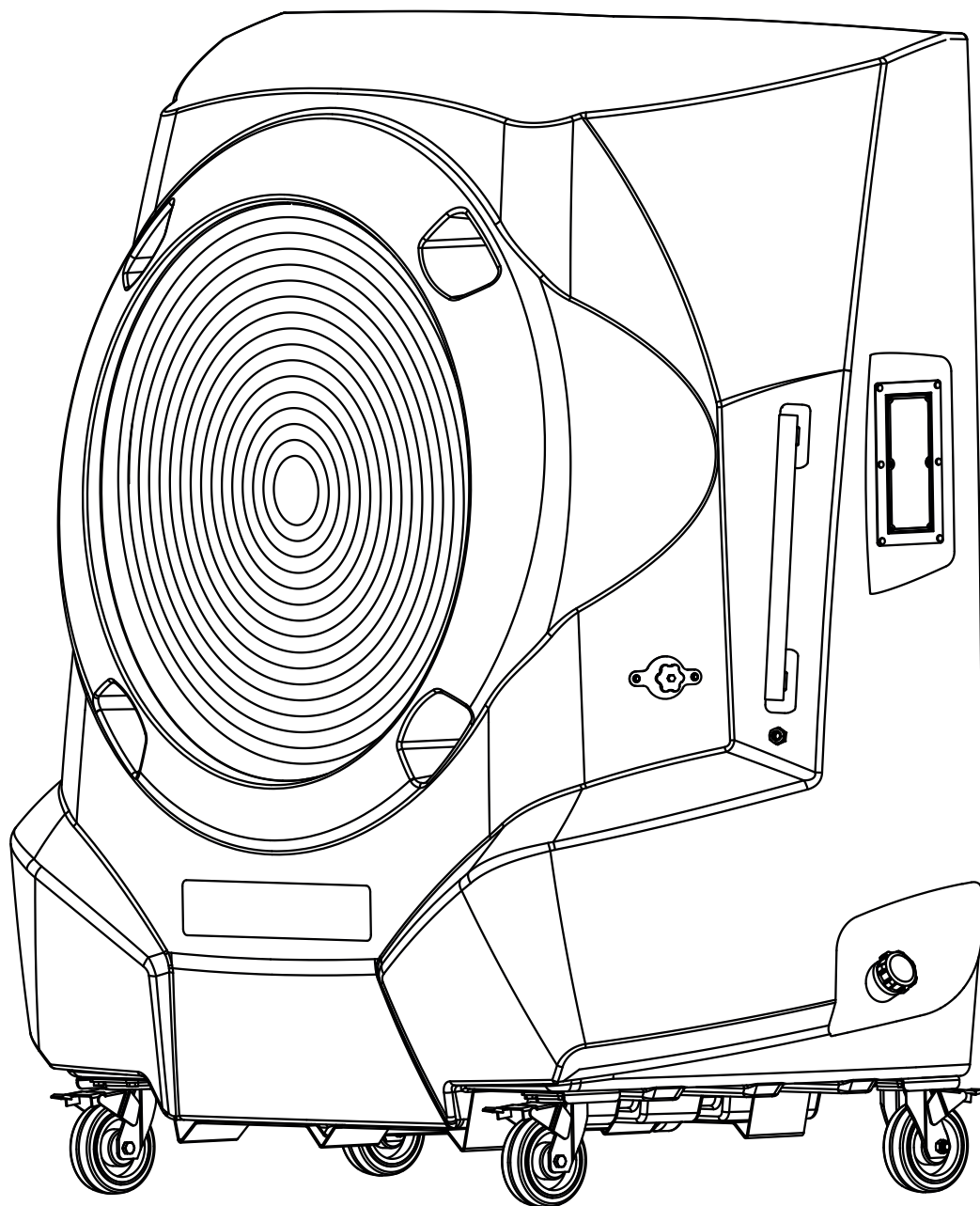

FIGURES - FIGURE - ABBILDUNGEN - FIGURAS - FIGURES - FIGUREN - FIGURAS - FIGURER - KUVAT - FIGURER - FIGURER - ILUSTRACJE - ИЛЛЮСТРАЦИИ - OBRÁZKY - ÁBRÁK - SLIKE - ŞEKİLLER - SLIKE - ILIISTRACIJOS - AT-TĒLI - JOONISED - IMAGINI - OBRÁZKY - СХЕМИ - ДАНИ - ΕΙΚΟΝΕΣ - 图示 - СУРЕТТЕМЕЛЕР

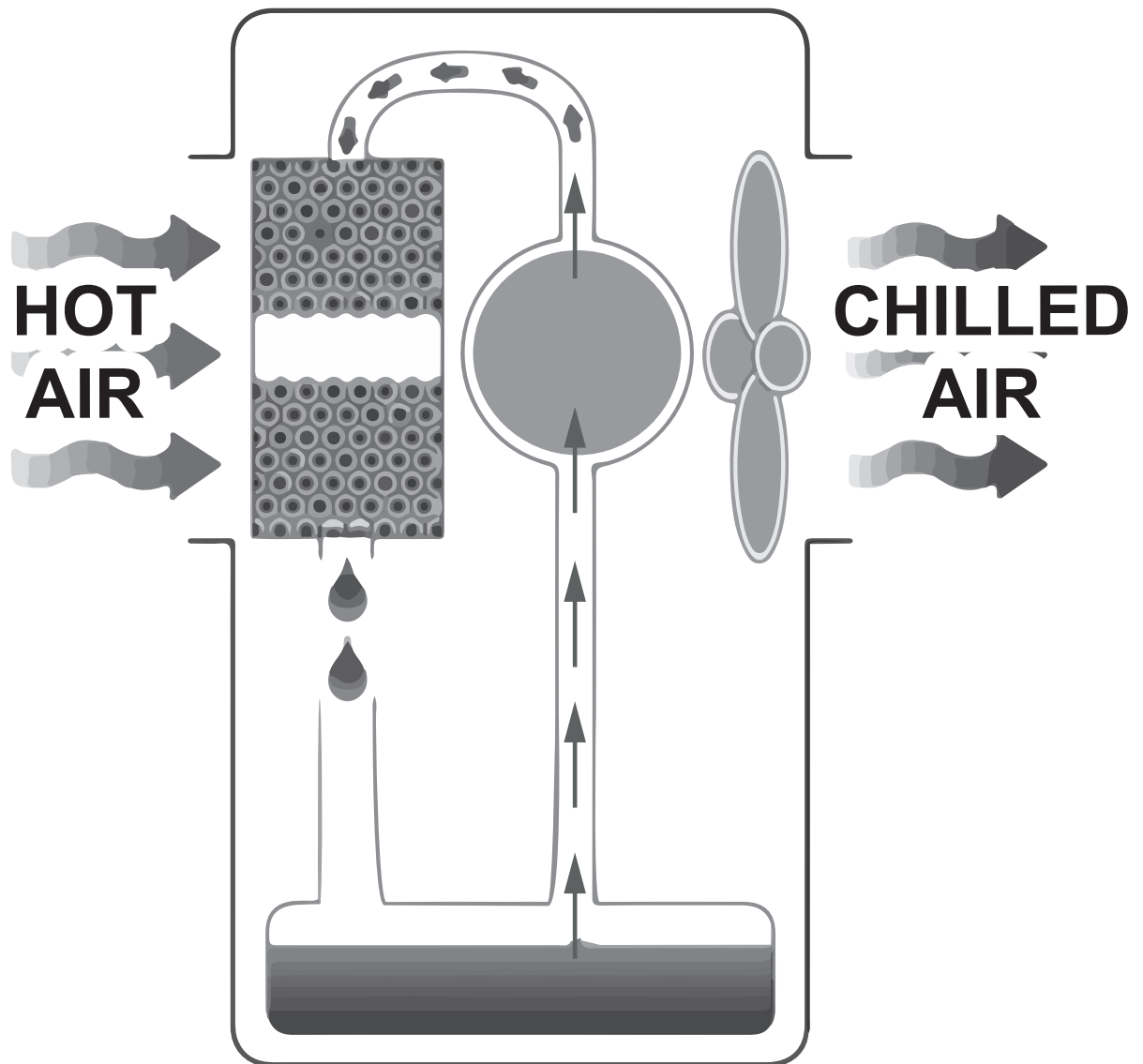

FIGURES - FIGURE - ABBILDUNGEN - FIGURAS - FIGURES - FIGUREN - FIGURAS - FIGURER - KUVAT - FIGURER - FIGURER - ILUSTRACJE - ИЛЛЮСТРАЦИИ - OBRÁZKY - ÁBRÁK - SLIKE - ŞEKİLLER - SLIKE - ILIISTRACIJOS - ATŲĖLI - JOONISED - IMAGINI - OBRÁZKY - СХЕМИ - ДАНИ - ΕΙΚΟΝΕΣ - 图示 - СУРЕТТЕМЕЛЕР

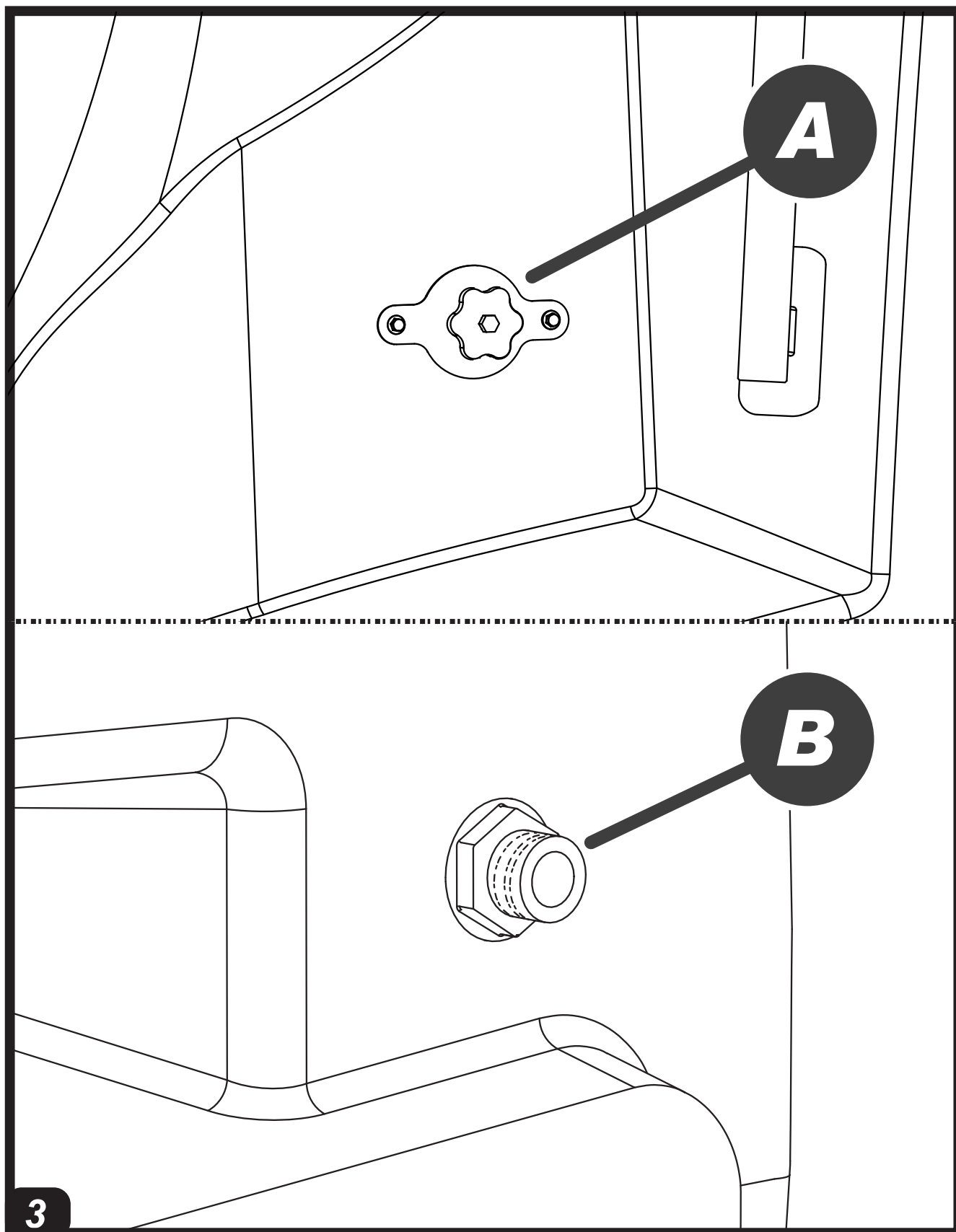

FIGURES - FIGURE - ABBILDUNGEN - FIGURAS - FIGURES - FIGUREN - FIGURAS - FIGURER - KUVAT - FIGURER - FIGURER - ILUSTRACJE - ИЛЛЮСТРАЦИИ - OBRÁZKY - ÁBRÁK - SLIKE - ŞEKİLLER - SLIKE - ILIISTRACIJOS - AT-TĒLI - JOONISED - IMAGINI - OBRÁZKY - СХЕМИ - ДАНИ - ΕΙΚΟΝΕΣ - 图示 - СУРЕТТЕМЕЛЕР

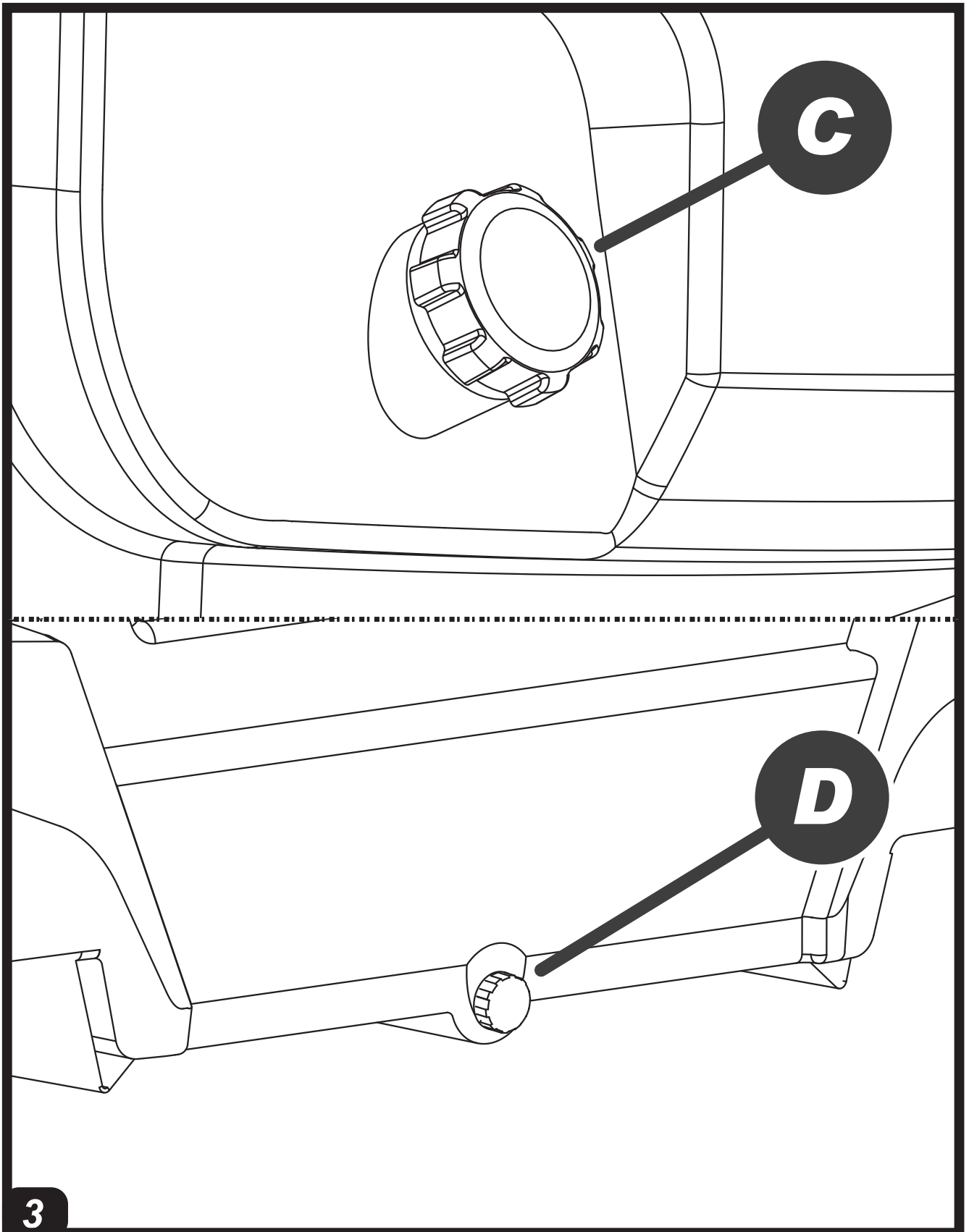

FIGURES - FIGURE - ABBILDUNGEN - FIGURAS - FIGURES - FIGUREN - FIGURAS - FIGURER - KUVAT - FIGURER - FIGURER - ILUSTRACJE - ИЛЛЮСТРАЦИИ - OBRÁZKY - ÁBRÁK - SLIKE - ŞEKİLLER - SLIKE - ILIISTRACIJOS - ATŲĖLI - JOONISED - IMAGINI - OBRÁZKY - СХЕМИ - ДАНИ - ΕΙΚΟΝΕΣ - 图示 - СУРЕТТЕМЕЛЕР

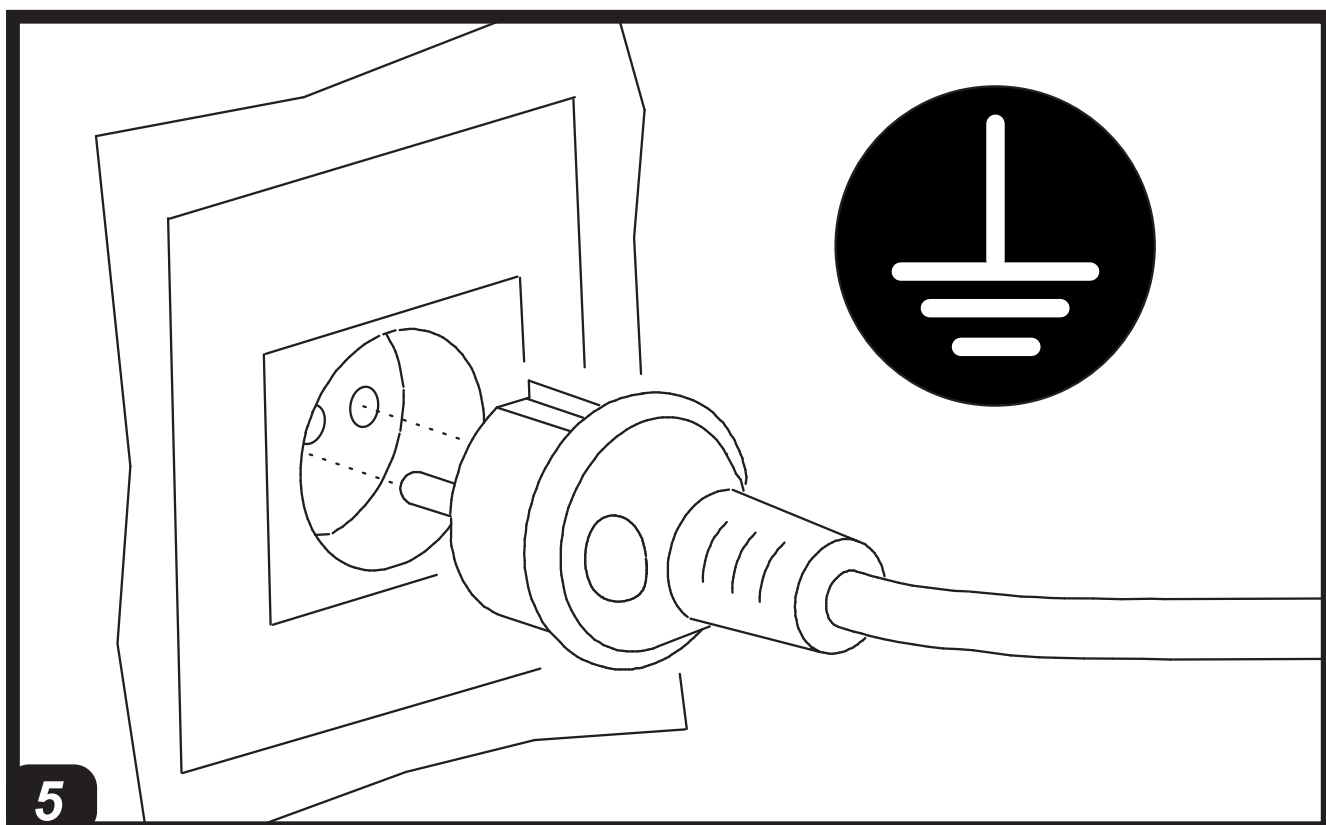
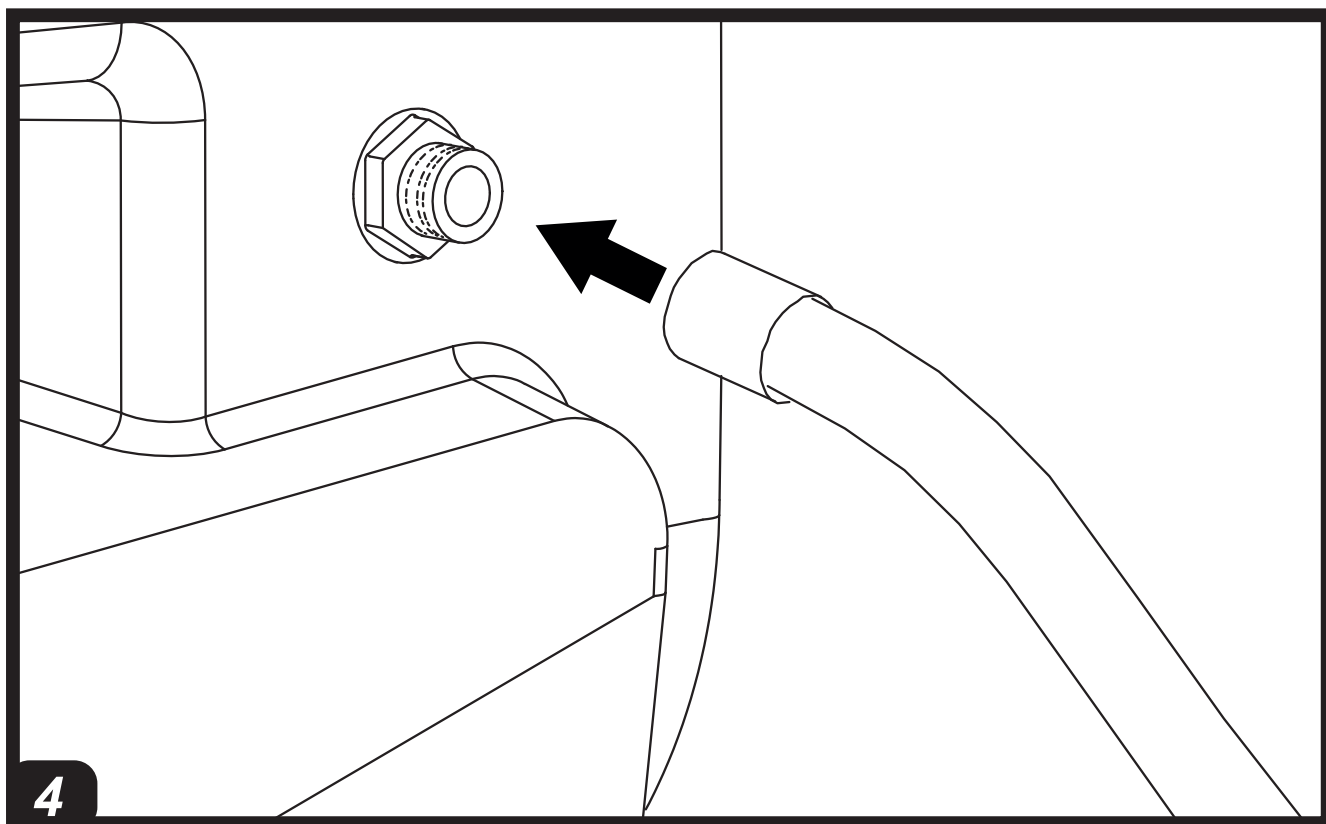

FIGURES - FIGURE - ABBILDUNGEN - FIGURAS - FIGURES - FIGUREN - FIGURAS - FIGURER - KUVAT - FIGURER - FIGURER - ILUSTRACJE - ИЛЛЮСТРАЦИИ - OBRÁZKY - ÁBRÁK - SLIKE - ŞEKİLLER - SLIKE - ILIISTRACIJOS - ATĒLI - JOONISED - IMAGINI - OBRÁZKY - СХЕМИ - ДАНИ - ΕΙΚΟΝΕΣ - 图示 - СУРЕТТЕМЕЛЕР

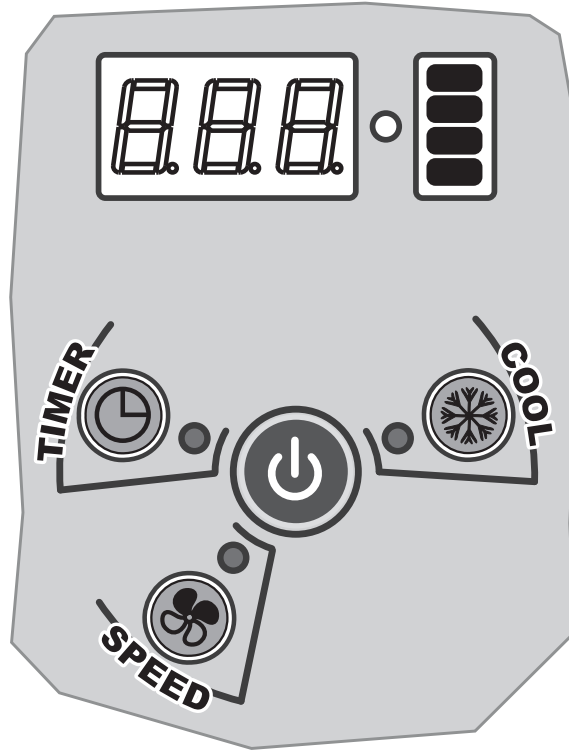

FIGURES - FIGURE - ABBILDUNGEN - FIGURAS - FIGURES - FIGUREN - FIGURAS - FIGURER - KUVAT - FIGURER - FIGURER - ILUSTRACJE - ИЛЛЮСТРАЦИИ - OBRÁZKY - ÁBRÁK - SLIKE - ŞEKİLLER - SLIKE - ILIISTRACIJOS - AT-TĒLI - JOONISED - IMAGINI - OBRÁZKY - СХЕМИ - ДАНИ - ΕΙΚΟΝΕΣ - 图示 - СУРЕТТЕМЕЛЕР

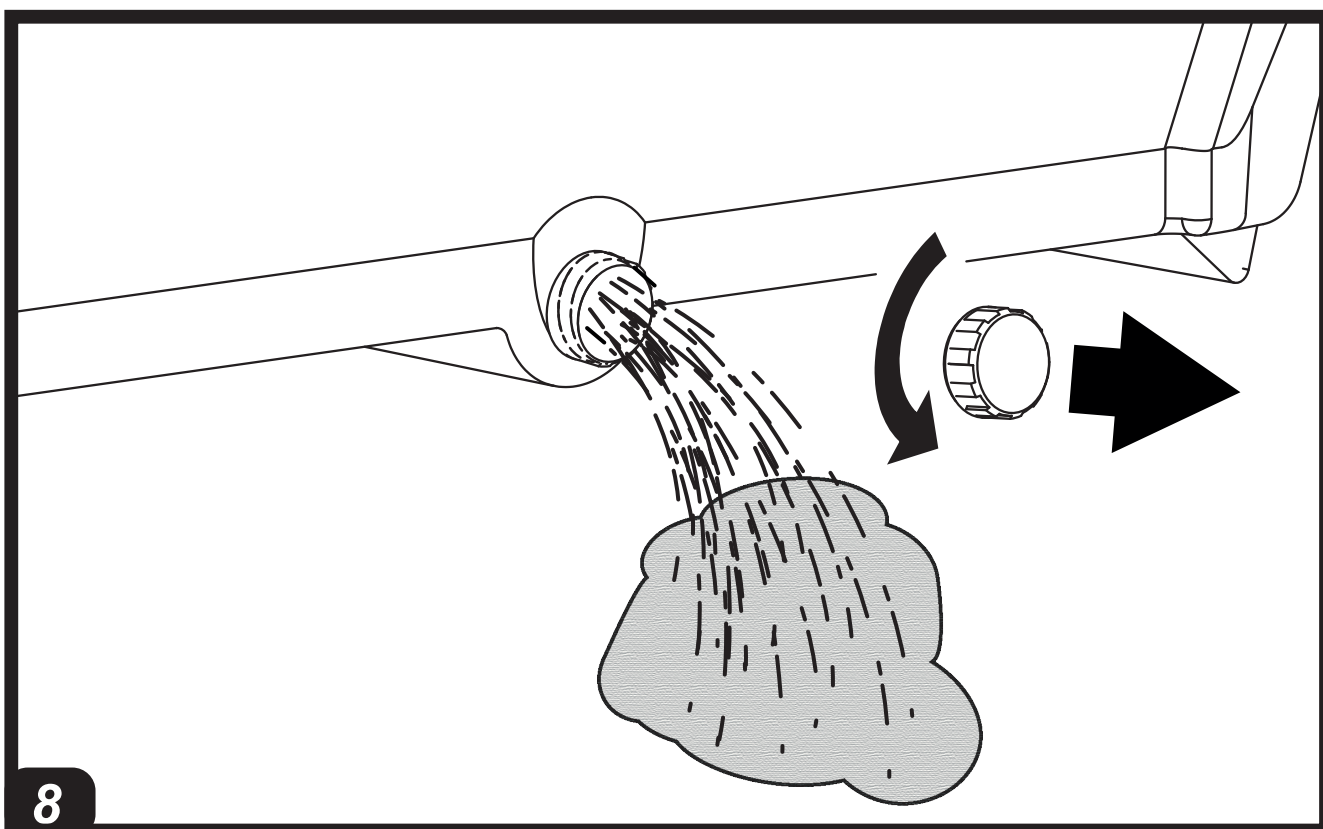
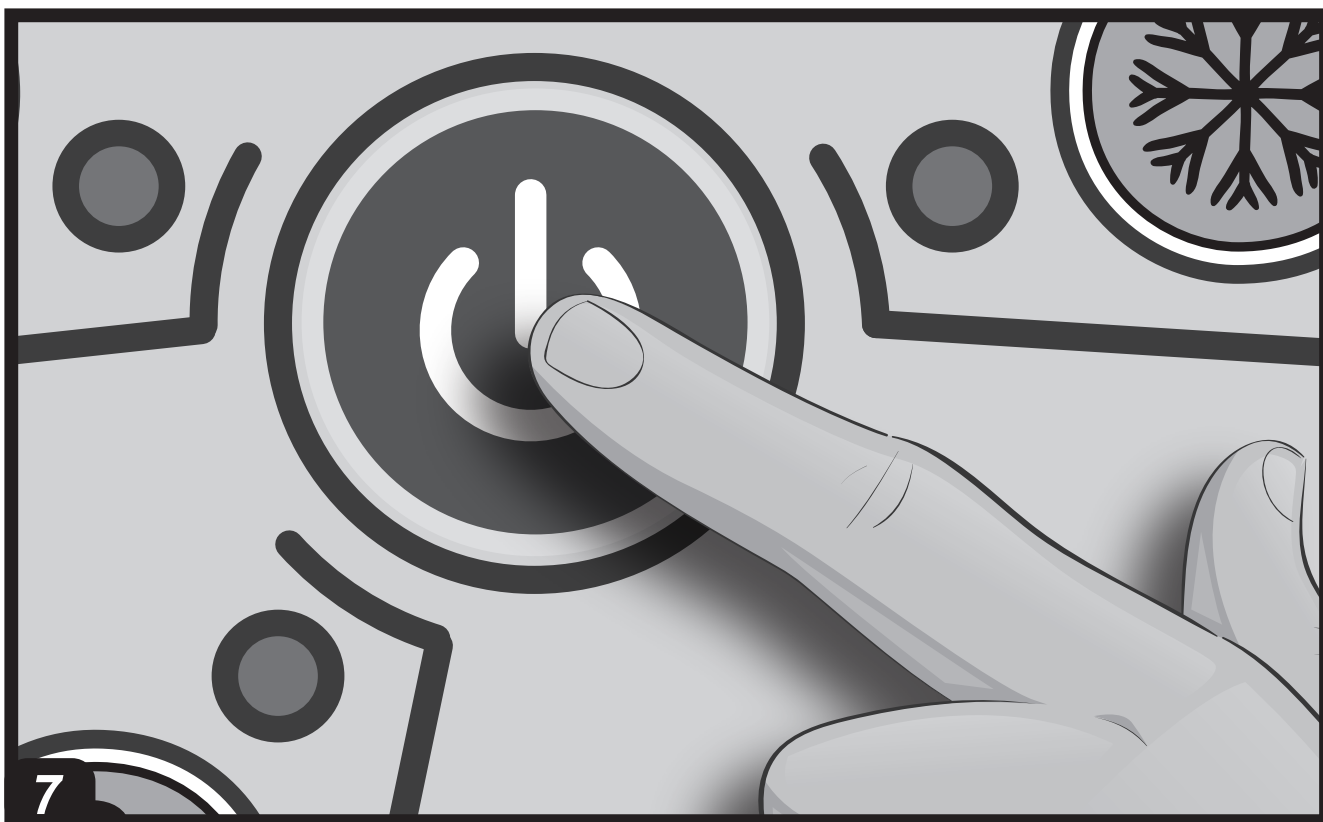

FIGURES - FIGURE - ABBILDUNGEN - FIGURAS - FIGURES - FIGUREN - FIGURAS - FIGURER - KUVAT - FIGURER - FIGURER - ILUSTRACJE - ИЛЛЮСТРАЦИИ - OBRÁZKY - ÁBRÁK - SLIKE - ŞEKİLLER - SLIKE - ILIISTRACIJOS - AT-TĒLI - JOONISED - IMAGINI - OBRÁZKY - СХЕМИ - ДАНИ - ΕΙΚΟΝΕΣ - 图示 - СУРЕТТЕМЕЛЕР

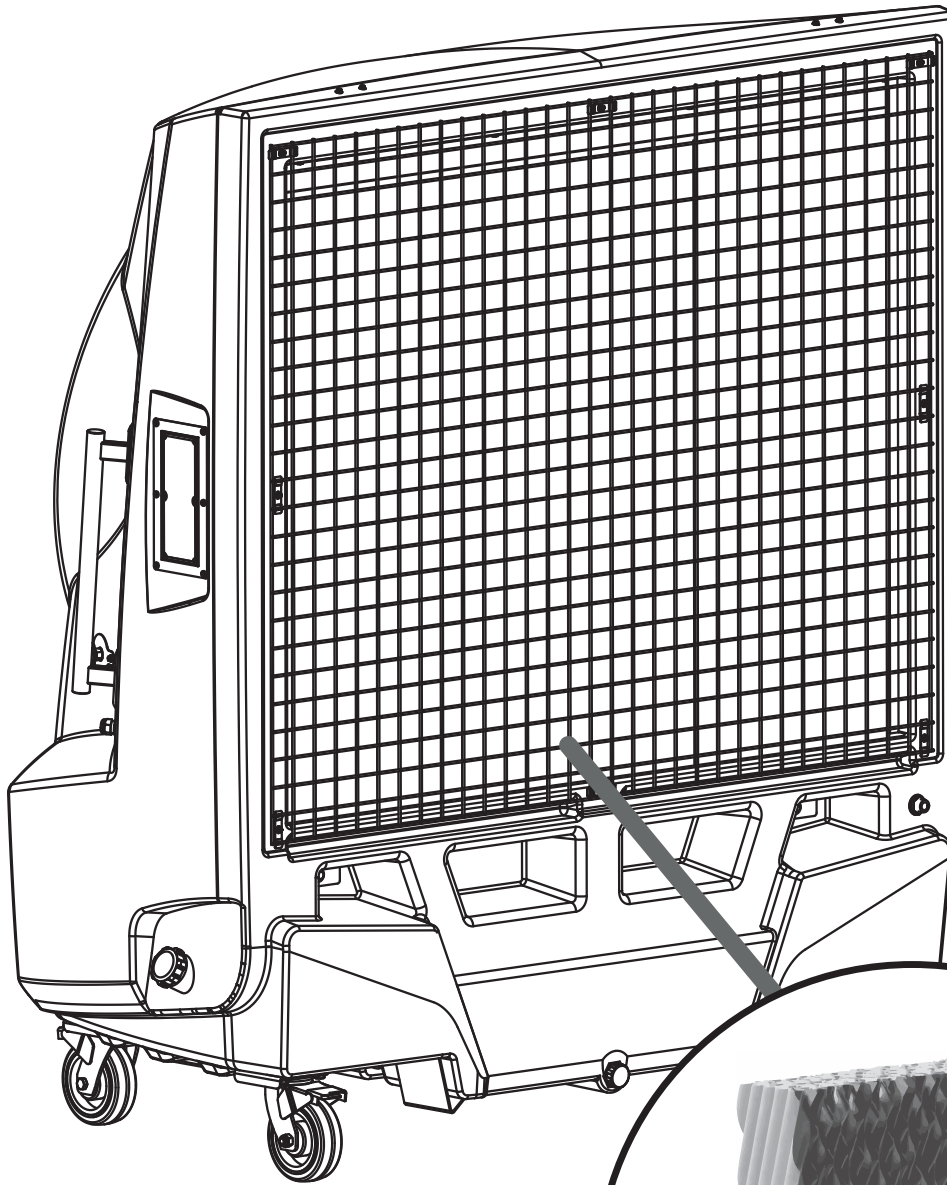

▶▶ 1. SAFETY INFORMATION

(Fig. 1)

⚠ IMPORTANT: READ AND UNDERSTAND THIS OPERATIONAL MANUAL BEFORE ASSEMBLING, COMMISSIONING OR PERFORMING MAINTENANCE ON THIS APPLIANCE. INCORRECT USE OF THE APPLIANCE CAN CAUSE SERIOUS INJURY. KEEP THIS MANUAL FOR FURTHER REFERENCE.

⚠ IMPORTANT: This appliance is not suitable for use by persons (including children) with reduced physical, sensory or mental capacities or who lack experience or knowledge unless supervised by a person responsible for their safety. Children must be supervised to make sure they do not play with the appliance.

- ▶ 1.1. Only fill the cooler tank only with clean water.
- ▶ 1.2. Before carrying out any operation, make sure the cooler, including the power supply cable and the control panel are perfectly dry, in order to avoid any risk.
- ▶ 1.3. After filling the tank, handle the cooler carefully.
- ▶ 1.4. Comply with all local legislation and current regulations when using the cooler.
- ▶ 1.5. Keep the cooler dry, in order to avoid electric shocks. Hands must always be dry.
- ▶ 1.6. Use only in ventilated and dry areas.
- ▶ 1.7. For indoor use only.
- ▶ 1.8. Only power the cooler with the voltage and frequency as specified on the nameplate.
- ▶ 1.9. Do not cover the cooler with paper, cardboard, plastic, metal sheets or any other inflammable material during use, in order to prevent any risk.
- ▶ 1.10. The cooler must be used on a stable and levelled surface, in order to prevent any risk.
- ▶ 1.11. Disconnect the cooler from the mains power supply when not in use.
- ▶ 1.12. Never block the cooler's air vents or the air outlet.
- ▶ 1.13. The minimum safety distance recommended between the cooler and walls or other items is 0,5 m.
- ▶ 1.14. Never move, handle, refuel or conduct maintenance on the cooler when it is connected to the mains or in operation.
- ▶ 1.15. The cooler (power cable included) must be kept at a suitable safety distance from heat sources.
- ▶ 1.16. In any case, the cooler must be opened and/or repaired by authorised after-sales centre.
- ▶ 1.17. If the power supply cable is damaged, it must be replaced by a technical support centre to prevent any risk.
- ▶ 1.18. In the event of incorrect cooler operation, immediately disconnect the electrical power supply and contact the support centre.
- ▶ 1.19. Protect the power cable from potential damage caused by the movement of vehicles or pedestrians. Improper connection to electrical voltage or improper installation may result in electric shocks.
- ▶ 1.20. Conditions of use:
 - A) Temperature of the air: 18°C - 45°C; Temperature of the water: <45°C.
 - B) The air must be free of dust and pollutants, otherwise cleaning must be carried out more frequently.
- ▶ 1.21. The water used to fill the cooler tank must come from an aqueduct. If it is not possible to draw from an aqueduct, the water introduced must be subjected to a sanitation treatment, according to European Directive 98/82/EC.
 - We recommend using water with a hardness of less than 15°f.
 - The cooler tank must be emptied and sanitised periodically depending on the use.
 - The evaporative panel surfaces must be periodically inspected and sanitised depending on the use.
 - For sanitation operations, biocidal products that comply with European regulation no. 582/2012 must be used.

►► 2. UNPACKING

- 2.1. Remove all packaging material used to pack and deliver the cooler and dispose of it in compliance with current standards.
- 2.2. Check for any damage incurred during transport. If the cooler appears damaged, immediately inform the dealer from whom it was purchased.

►► 3. DESCRIPTION

(Fig. 2)

Evaporative coolers cool the air by using the natural process of evaporation of water. Operation of these air coolers is based on evaporative cooling that uses the energy exchange between the water and air.

The coolers consist of an evaporative panel, a fan and a cascade water distribution system. The fan draws air from outside and passes it through the evaporative panel, which is made entirely of cellulose and is constantly wet by a special system that pumps water.

►► 4. OPERATION

WARNING: Carefully read the “SAFETY INFORMATION” before switching on the cooler.

WARNING: Only use clean water to prevent failures or other anomalies.

WARNING: Verify if your electronic system is earthed correctly. Connection to the mains must be made in compliance with the National Standards in force. Only power the cooler with the voltage and frequency as specified on the nameplate.

The cooler is equipped with a series of fittings and cocks (Fig. 3):

► WATER FLOW ADJUSTMENT COCK (A Fig. 3):

Used to adjust the water supply to the cooler. A maximum water flow rate is obtained with the cock completely open (anticlockwise rotation of the knob).

► WATER SUPPLY FITTING (B Fig. 3):

This is used for the continuous and automatic supply of water to the cooler (1/2” fitting and maximum inlet water pressure of 3 bar). After filling, it can also be moved, always with the utmost care.

► MANUAL WATER SUPPLY COCK (C Fig. 3):

A water filling cock is provided, which enables manually filling of the tank.

NOTE: Take note of the maximum capacity of the tank in order to avoid overflows.

► DRAIN COCK (D Fig. 3):

The base of the cooler is equipped with a drain cock, which is used to drain water from the tank.

►► 4.1. SWITCH-ON:

- 4.1.1. Connect the cooler to the water mains using the threaded fitting (Fig. 4).
- 4.1.2. Refilling the water tank. When water in the tank reaches the maximum level, a float will automatically block the flow (it is possible to operate the cooler while being continuously connected and fed from water mains supply).
In case of manual refilling from the cock, pay attention to the tank’s capacity in order to avoid overflows.
- 4.1.3. Check that there were no leaks during refuelling.
- 4.1.4. Connect the supply plug to the power mains (Fig. 5).
- 4.1.5. Press ON/OFF / POWER to turn on the cooler (Fig. 7).

►► 4.2. FUNCTIONS OF THE CONTROL PANEL AND REMOTE CONTROL (Fig. 6):

- ON/OFF / POWER: Is used to turn the cooler on or off.
- SPEED: Increases or decreases the ventilation speed of the cooler. You can choose from three speeds.
- COOL: Enables or disables the cooling mode.
- TIMER: Enables to activate or deactivate the delayed switch-on or switch-off mode.

-DELAYED SWITCH-ON: When the cooler is on, press the "TIMER" button repeatedly until the desired time is displayed (the number flashes), then SWITCH OFF THE COOLER.

-DELAYED SWITCH-OFF: When the cooler is on, press the "TIMER" button repeatedly until the desired time is displayed, then the switch-off time is set.

NOTE: When the cooler emits an acoustic beep, it means that the tank is empty and the device is operating in fan mode. To restore correct operation in "COOL" mode, refill the water tank. To deactivate the acoustic beep, deactivate the "COOL" function.

▶▶ 4.3. SWITCH-OFF:

- ▶ 4.3.1. Press ON/OFF / POWER to turn off the cooler (Fig. 7).
- ▶ 4.3.2. Drain the tank through the specific drain plug (Fig. 8).

▶▶ 5. CLEANING AND MAINTENANCE

WARNING: BEFORE PERFORMING ANY MAINTENANCE OR REPAIR, DISCONNECT THE POWER CABLE FROM THE MAINS.

DEPENDING ON THE ENVIRONMENT WHERE THE COOLER IS USED, DUST, DIRT OR WATER QUALITY CAN AFFECT THE PERFORMANCE OF THE UNIT. THEREFORE, CLEANING THE FOLLOWING COMPONENTS MAY BE REQUIRED:

▶▶ 5.1. TANK:

IT IS RECOMMENDED TO READ THE SAFETY WARNINGS CAREFULLY AND TO CHANGE THE WATER FREQUENTLY.

- ▶ 5.1.1. Turn off the cooler and disconnect the plug from the power mains.
- ▶ 5.1.2. Drain the tank through the specific drain plug (Fig. 8).

▶▶ 5.2. EVAPORATIVE PANELS AND WATER CIRCUIT:

- ▶ 5.2.1. It is recommended to visually check the condition and correct position of the evaporative panels on a regular basis (Fig.

9). The panels must not be worn, damaged or encrusted and must be positioned correctly in order to avoid gaps between each other.

IMPORTANT: Do not attempt to remove the evaporative panels. All operations must be carried out by the after-sales assistance service.

IMPORTANT: Handle the evaporative panels with care; do not drill or insert pointed objects in the air inlet grille.

- ▶ 5.2.2. To ensure proper operation of the cooler, turn off the COOL mode a few minutes before completely switching off the cooler, in order to avoid stagnant water.
- ▶ 5.2.3. We recommend periodically performing a complete cycle using clean water and appropriate disinfection products, running the cooler outdoors.

IMPORTANT:

-The cooler tank must be emptied and sanitised periodically depending on the use.

-The evaporative panel surfaces must be periodically inspected and sanitised depending on the use.

-For sanitation operations, biocidal products that comply with European regulation no. 582/2012 must be used.

▶▶ 6. REMOTE HUMIDISTAT CONNECTION (optional)

A remote humidistat can be connected in series to the power supply plug, to manage automatic switch-on or switch-off of the cooler.





After the humidistat has been activated, during normal operation, the cooler switches off. The re-ignition is automatic and the operating configuration is restored keeping the settings prior to switch-off.

CAUTION: THE ONLY SETTING THAT IS NOT RESTORED IS THE "TIMER" FUNCTION, IN THIS CASE IN FACE THE COOLER WILL GO IN STAND-BY CONDITION.

►► 7. TROUBLESHOOTING

FAULT	CAUSE	SOLUTION
The display does not work	1. No power supply 2. Defective equipment	1a. Make sure that the device is connected to the power supply 1b. Contact a support centre 2. Contact a support centre
There is no air flow or it is very low	1. Rear side air vent clogged 2. Defective equipment	1a. Keep the rear part of the cooler away from walls that may obstruct the airflow 1b. Remove any objects from the air vent 1c. Contact a support centre 2. Contact a support centre
The device does not respond to the commands	1. Defective equipment	1. Contact a support centre
The device leaks water	1. The drainage plug is loose 2. The drain is dirty and the drainage plug does not fully close 3. The tank leaks 4. The panel is dripping	1. Close the plug 2. Clean the drain and close the plug 3. Contact a support centre 4. Contact a support centre

TECHNICAL DATA - DATI TECNICI - TECHNISCHE DATEN - DATOS TÉCNICOS - DONNÉES TECHNIQUES - TECHNISCHE GEGEVENS - DADOS TÉCNICOS - TEKNISKE DATA - TEKNISET TIEDOT - TEKNISKE DATA - TEKNISKA DATA - DANE TECHNICZNE - ТЕХНИЧЕСКИЕ ДАННЫЕ - TECHNICKÉ ÚDAJE - MŰSZAKI ADATOK - TEHNIČNI PODATKI - TEKNİK VERİLER - TEHNIČKI PODACI - TECHNINIAI DUOMENYS - TEHNISKIE DATI - TEHNILISED ANDMED - DATE TEHNICE - TECHNICKÉ ÚDAJE - ТЕХНИЧЕСКИ ДАННИ - ТЕХНІЧНІ ДАНІ - TEHNIČKI PODACI - ТЕХНІКА ДЕДОМЕНА - 技术参数 - ТЕХНИКАЛЫҚ КӨРСЕТКІШТЕР

MODEL	BC 341
	30.000 m ³ /h-m ³ /ч
	200 l-л
	220-240 V-B 50 Hz-Гц 5,4 A 1.100 W-Вт
	130 kg-кг
	IPX1

⚠ IMPORTANT: In order to have a correct function you must use an electrical generator in class G3 or more (frequency variation $\pm 1\%$, tension variation $\pm 2\%$). The maximum power of electrical generator must be three time the nominal power of device that you must connect.

WIRING DIAGRAMS - SCHEMI ELETTRICI - SCHALTPLÄNE - ES-QUEMAS ELÉCTRICOS - SCHEMAS ELECTRIQUES - ELEKTRISCHE SCHEMA'S - ESQUEMAS ELÉCTRICOS - ELEKTRISKE SKEMAER - SÄHKÖKAAVIOT - KOPLINGSSKJEMA - ELEKTRISKA KOPPLINGSSCHEMAN - SCHEMATY ELEKTRYCZNE - ЭЛЕКТРИЧЕСКИЕ СХЕМЫ - ELEKTRICKÁ SCHÉMATA - VILLANYBEKÖTÉSI RAJZOK - ELEKTRIČNE SHEME - ELEKTRİK ŞEMALARI - ELEKTRIČNE SHEME - ELEKTROS SCHEMOS - ELEKTRISKĀS SHĒMAS - ELEKTRISKEEMID - SCHEME ELECTRICHE - ELEKTRICKÉ SCHÉMY - ЭЛЕКТРИЧЕСКИ СХЕМИ - ЕЛЕКТРИЧНІ СХЕМИ - ELEKTRIČNE ŠEME - ΗΛΕΚΤΡΙΚΑ ΣΧΕΔΙΑ - 线路图 - ЭЛЕКТРЛІ СУЛБЕЛЕР

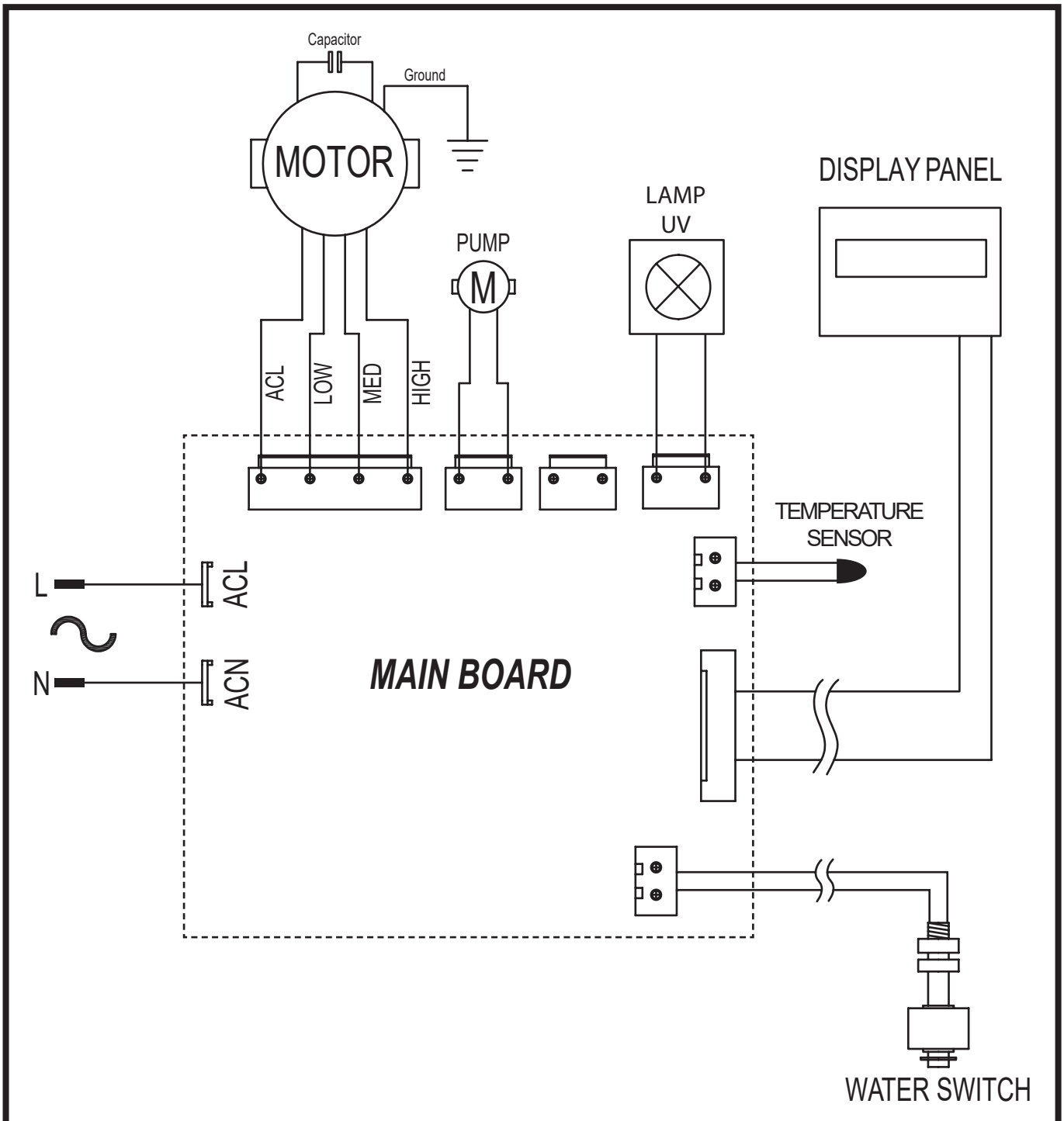

CE CONFORMITY CERTIFICATE



CE CONFORMITY CERTIFICATE - DICHIARAZIONE DI CONFORMITÀ CE - EG-KONFORMITÄT-SERKLÄRUNG - DECLARACIÓN DE CONFORMIDAD CE - DECLARATION DE CONFORMITE CE - EG-CONFORMITEITVERKLARING - DECLARAÇÃO DE CONFORMIDADE CE - EU-OVERENSSTEMMELSESERKLÆRING - EY-VAATIMUSTENMUKAISUUSVAKUUTUS - CE-SAMSVAR-SERKLÆRING - EG-FÖRSÄKRAN OM ÖVERENSSTÄMMELSE - DEKLARACJA ZGODNOŚCI WE - ДЕКЛАРАЦИЯ О СООТВЕТСТВИИ CE - PROHLÁŠENÍ O SHODĚ CE - EK MEGFELELŐSÉGI NYILATKOZAT - IZJAVA O SKLADNOSTI IN OZNAKA CE - CE UYGUNLUK BEYANI - IZJAVA CE O SUKLADNOSTI - ES ATITIKTIES DEKLARACIJA - EK ATBILSTĪBAS - DEKLARĀCIJA - EÜ VASTAVUSDEKLARATSIOON - DECLARAȚIE DE CONFORMITATE CE - PREHLÁSENIE O ZHODE CE - ДЕКЛАРАЦИЯ ЗА СЪВМЕСТИМОСТ CE - ДЕКЛАРАЦИЯ ВІДПОВІДНОСТІ CE - IZJAVA CE O PRIKLADNOSTI ΔΗΛΩΣΗ ΣΥΜΜΟΡΦΩΣΗΣ CE - CE 符合性声明

DANTHERM S.p.A. Via Gardesana 11, -37010- Pastrengo (VR), ITALY

Product: - Prodotto: - Produkt: - Producto: - Produit: - Product: - Produto: - Produkt: - Tuote: - Produkt: - Produkt: - Produkt: - Изделие: - Výrobek: - Termék: - Izdelek: - Ürün: - Proizvod: - Gaminys: - Ieīce: - Toode: - Produsul: - Výrobok: - Продукт: - Виріб: - Proizvod: - Προϊόν: - 产品:

BC 341

We declare that it is compliant with: - Si dichiara che è conforme a: - Es wird als konform mit den folgenden Normen erklärt: - Se declara que está en conformidad con: - Nous déclarons sa conformité à: - Hierbij wordt verklaard dat het product conform is met: - Declara-se que está em conformidade com: - Vi erklærer at produktet er i overensstemmelse med: - Vakuutetaan olevan yhdenmukainen: - Man erklærer at apparatet er i overensstemmelse med: - Härmed intygas det att produkten är förenlig med följande: - Oświadcza się, że jest zgodny z: - Заявляем о соответствии требованиям: - Prohlašuje se, že je v souladu s: - Kijelentjük, hogy a termék megfelel az alábbiaknak: - Izpolnjuje zahteve: - Aşağıdaki standartlara uygun olduğunu beyan ederiz: - Izjavljuje se da je u skladu s: - Pareiškiame, kad atitinka: - Tiek deklarēts, ka atbilst: - Käesolevaga deklareeritakse, et toode vastab: - Declarăm că este conform următoarelor: - Prehlasuje sa, že je v súlade s: - Декларира се че отговаря на: - Відповідає вимогам: - Izjavljuje se da je u skladu s: - Δηλώνουμε ότι είναι σύμφωνο με: - 兹证明符合:

2014/35/EU, 2011/65/EU, 2009/125/EC

EN 60335-1:2012/A11:2014, EN 60335-2-98:2003/A2:2008, (EU) N°. 327/2011

Pastrengo, 2020

Stefano Verani (Member of the Board)

► en - DISPOSAL OF THE PRODUCT

-This product has been designed and manufactured with top-quality materials and components, which can be re-cycled and re-used. When a crossed-wheely bin symbol is attached to the product, it means that the product is protected by the, 2012/19/UE European Directive.

-Please obtain information regarding the local differentiated collection system for electrical and electronic products.

-Respect local Standards in force and do not dispose of old products as normal domestic waste. Correct disposal of the product helps to prevent possible negative consequences for health, the environment and mankind.

► it - SMALTIMENTO DEL PRODOTTO

-Questo prodotto è stato progettato e fabbricato con materiali e componenti di alta qualità, che possono essere riciclati e riutilizzati.

-Quando ad un prodotto è attaccato il simbolo del bidone con le ruote segnato da una croce, significa che il prodotto è tutelato dalla Direttiva Europea 2012/19/UE.

-Si prega di informarsi in merito al sistema locale di raccolta differenziata per i prodotti elettrici ed elettronici.

-Rispettare le norme locali in vigore e non smaltire i prodotti vecchi nei normali rifiuti domestici. Il corretto smaltimento del prodotto aiuta ad evitare possibili conseguenze negative per la salute dell'ambiente e dell'uomo.

► de - ENTSORGUNG DES PRODUKTS

-Dieses Produkt wurde unter Verwendung von Qualitätsmaterialien und -bauteilen entwickelt und hergestellt, die recycelt und wieder verwendet werden können.

-Ist ein Produkt gekennzeichnet durch die Mülltonne mit Rädern und einem Kreuz, wird hier angezeigt, dass dieses Produkt durch die europäische Direktive 2012/19/UE überwacht ist.

-Es wird gebeten, sich über die vor Ort bestehende Mülltrennung bezüglich elektrischer und elektronischer Produkte zu informieren.

-Die vor Ort geltenden Vorschriften zur Müllentsorgung müssen eingehalten werden und alte Produkte dürfen nicht zusammen mit dem Hausmüll entsorgt werden. Die ordnungsgemäße Entsorgung des Produkts hilft mögliche negative Folgen für Gesundheit und Umwelt zu vermeiden.

► es - ELIMINACIÓN DEL PRODUCTO

-Este producto ha sido diseñado y fabricado con materiales y componentes de alta calidad que se pueden reciclar y reutilizar.

-Cuando en el producto se encuentra el símbolo del contenedor con las ruedas tachado con una cruz, significa que el producto está tutelado por la Directiva europea 2012/19/UE.

-Se ruega informarse acerca del sistema local de recogida selectiva para los productos eléctricos y electrónicos.

-Respete las normas locales vigentes y no elimine los productos viejos junto con los residuos domésticos normales. La eliminación correcta del producto ayuda a evitar posibles consecuencias negativas para la salud del ambiente y del hombre.

► fr - SE DÉBARRASSER DE VOTRE PRODUIT USAGÉ

-Ce produit a été conçu et fabriqué avec des matériaux et des composants de haute qualité, qui peuvent être recyclés et utilisés de nouveau.

-Lorsque le symbole d'une poubelle à roue barrée est appliqué à un produit, cela signifie que le produit est couvert par la Directive Européenne 2012/19/UE.

-Veuillez vous informer du système local de séparation des déchets électriques et électroniques.

-Veuillez agir selon les règles locale set ne pas jeter vos produits usagés avec les déchets domestiques usuels. Jeter correctement votre produit usagé aidera à prévenir les conséquences négatives potentielles contre l'environnement et la santé humaine.

► nl - VERWIJDERING VAN HET PRODUCT

-Dit product werd ontworpen en gemaakt met hoogwaardige materialen en componenten, die gerecycleerd en herbruikt kunnen worden.

-Wanneer op een product het symbool van de afvalbak op wielen met een kruis erdoor is aangebracht, betekent dit dat het product valt onder de Europese Richtlijn 2012/19/UE.

-Gelieve inlichtingen in te winnen betreffende het plaatselijke systeem voor gedifferentieerde inzameling van elektrische en elektronische toestellen.

-Respecteer de plaatselijke normen die van kracht zijn, en verwijder de oude toestellen niet als gewoon huishoudelijk afval. Een correcte verwijdering van het product helpt om mogelijke negatieve gevolgen voor de gezondheid van mens en milieu te voorkomen.

► pt - ELIMINAÇÃO DO PRODUTO

-Este produto foi projetado e fabricado com materiais e componentes de alta qualidade que podem ser reciclados e reutilizados.

-Quando for afixado em um produto o símbolo do bidão com rodas marcado com uma cruz, significa que o produto é protegido pela Diretiva Europeia 2012/19/UE.

-Solicitamos informar-se sobre o sistema local de recolha diferenciada para os produtos elétricos e eletrônicos.

-Respeitar as normas locais em vigor e não eliminar os produtos antigos como normais detritos domésticos. A correta eliminação do produto ajuda a evitar possíveis consequências negativas para a saúde do ambiente e do homem.

Dantherm S.p.A.

Via Gardesana 11, -37010-
Pastrengo (VR), Italy

Dantherm S.p.A.

Виа Гардесана 11, 37010
Пастренго (Верона), Италия

Dantherm Sp. z o.o.

ul. Magazynowa 5A,
62-023 Gądkі, Poland

Dantherm Sp. z o.o.

ул. Магазинова, 5А,
62-023 Гадки, Польша

Dantherm LLC

ul. Transportnaya 22/2,
142802, STUPINO, Moscow region, Russia

ООО «Дантерм»

Ул. Транспортная, 22/2,
142802, г. Ступино, Московская обл., РФ

Dantherm China LTD

Unit 2B, 512 Yunchuan Rd.,
Shanghai, 201906, China

Dantherm China LTD

Юньчуань роад, 512, строение 2В,
Шанхай, 201906, Китай

Dantherm SP S.A.

C/Calabozos, 6 Polígono Industrial, 28108
Alcobendas (Madrid) Spain

Dantherm SP S.A.

Ц/Калабозос, 6 Полигоно Индустириал,
28108 Алкобендас (Мадрит) Испания